

Giunti a soffietto metallico senza gioco **AK**

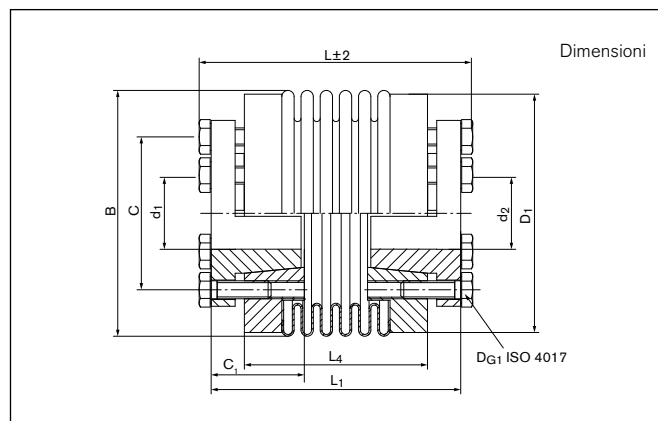

Dimensioni

d₁;d₂_{min} = Min. diametro del foro d₁/d₂
d₁;d₂_{max} = Max. diametro del foro d₁/d₂
B = Diametro esterno soffietto
C = Circonferenza primitiva

C₁ = Lunghezza guidata in foratura del mozzo
D₁ = Diametro esterno
L = Lunghezza totale

L₁ = Lunghezza giunto
L₄ = Lunghezza giunto (senza cono/anello di serraggio)

Grandezza	d ₁ ;d ₂ min-max	B	C	C ₁	D ₁	L±2	L ₁	L ₄
	Senza sede chiave							
30	9 - 20	56	31	20	55	52/60	45/53	30/38
60	12 - 25	66	37	25	64	63/73	55/65	35/46
80	15 - 35	82	51	30	80	79/91	72/83	49/61
150	15 - 35	82	51	30	80	79/91	72/84	49/61
200	15 - 42	90	51/56	30	90	80/93	72/85	50/63
300	15 - 50	110	62/75	33	110	93/104	80/93	56/67
500	24 - 55	122	75/80	38	119	102/113	94/105	61/72
800	30 - 70	157	92/100	60	140	170	150	110
1400	35 - 70	157	92/100	60	140	170	150	110
3000	50 - 80	199	100/125	60	180	191	171	131
5000	60 - 90	250	100/125	65	230	199	179	139

Trasmissione della coppia di serraggio trasmissibile T degli accoppiamenti non può più essere garantita per fori < d_{min}. Possono però essere fornite tipi di fori < d_{min}.

Momento di inerzia e peso (massa) sono calcolati in base al diametro del foro più grande.

[Continua alla pagina successiva](#)

Giunti a soffietto metallico senza gioco **AK**

Dati tecnici

- T** = Coppia trasmissibile al valore T_A indicato
- n_{max}** = Max. numero di giri
- C_{Tdyn}** = Rigidità torsionale dinamica
- C_r** = Rigidità radiale
- C_a** = Rigidità assiale
- ΔK_a** = Massimo disallineamento assiale consentito
- ΔK_w** = Massimo disallineamento angolare consentito
- ΔK_r** = Massimo disallineamento radiale consentito
- J** = Momento di inerzia totale
- Gw** = Peso
- D_{G1}** = Diametro filetto
- T_{A1}** = Coppia di serraggio della vite di bloccaggio D_{G1}

Grandezza	T	n_{max}	C_{Tdyn}	C_r	C_a	ΔK_a	ΔK_w	ΔK_r	J	Gw	D_{G1}	T_{A1}
	Nm	1/min	10^3 Nm/rad	N/mm		mm	Gradi	mm	$10^{-3}kgm^2$	kg	mm	Nm
30	36	11000	35/25	720/220	50/30	0,4/0,5	1/1,5	0,1/0,2	0,15	0,281	6 x M4	3
60	72	9100	75/50	1100/330	90/55	0,4/0,5	1/1,5	0,1/0,2	0,24	0,482	6 x M6	8,5
80	96	7000	130/75	1200/400	80/55	0,4/0,5	1/1,5	0,2	0,65	0,846	6 x M6	10
150	180	7000	150/100	2000/600	150/85	0,4/0,5	1/1,5	0,2	0,65	0,846	6 x M6	14
200	240	6700	170/120	2500/450	150/85	0,4/0,5	1/1,5	0,2	0,87	1,005	6 x M6	14
300	360	5200	280/500	6300/1500	280/150	0,4/0,5	1/1,5	0,2	2,33	1,915	6 x M8	18
500	600	4600	680/310	8800/1000	100/85	0,5/1	1/1,5	0,2	5,73	2,448	6 x M8	26
800	800	3700	760	510	190	1	1,5	0,2	26,10	9,978	6 x M16	50
1400	1400	3700	1300	710	280	1	1,5	0,2	26,10	9,202	6 x M16	80
3000	3000	2800	2800	8060	880	1	1,5	0,2	86,83	14,57	6 x M16	130
5000	5000	2800	4800	9190	737	1	1,5	0,2	170,30	24,3	6 x M16	210

Coppia di serraggio trasmissibile T [Nm]

Grandezza	Ø9	Ø10	Ø12	Ø14	Ø15	Ø18	Ø20	Ø24	Ø28	Ø32	Ø38	Ø44	Ø48	Ø50	Ø58	Ø60	Ø65	Ø70	Ø75	Ø80	Ø85	Ø90	
30	36	36	36	36	36	36	36	---	---	---	---	---	---	---	---	---	---	---	---	---	---	---	---
60	---	---	72	72	72	72	72	---	---	---	---	---	---	---	---	---	---	---	---	---	---	---	---
80	---	---	---	---	96	96	96	96	96	96	---	---	---	---	---	---	---	---	---	---	---	---	---
150	---	---	---	---	180	180	180	180	180	180	---	---	---	---	---	---	---	---	---	---	---	---	---
200	---	---	---	---	240	240	240	240	240	240	240	---	---	---	---	---	---	---	---	---	---	---	---
300	---	---	---	---	290	350	360	360	360	360	360	360	360	---	---	---	---	---	---	---	---	---	---
500	---	---	---	---	---	---	---	600	600	600	600	600	600	600	---	---	---	---	---	---	---	---	---
800	---	---	---	---	---	---	---	---	800	800	800	800	800	800	800	800	800	800	---	---	---	---	---
1400	---	---	---	---	---	---	---	---	---	1400	1400	1400	1400	1400	1400	1400	1400	1400	---	---	---	---	---
3000	---	---	---	---	---	---	---	---	---	---	---	---	3000	3000	3000	3000	3000	3000	3000	3000	3000	---	---
5000	---	---	---	---	---	---	---	---	---	---	---	---	---	---	5000	5000	5000	5000	5000	5000	5000	5000	5000

Esempio di ordinazione: AK

Serie/Grandezza	Lunghezza	Diametro foro d_1	Diametro foro d_2	Ulteriori dettagli
AK 150	79	30	35	*

* Acciaio inox